

**amptweaker**<sup>TM</sup>  
good tone comes from tweaking ...

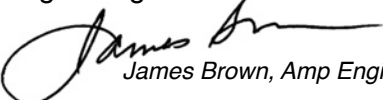

Thanks for purchasing your new **Bass TightFuzz<sup>TM</sup>** pedal, another **Amptweaker<sup>TM</sup>** handmade product designed with your advice. The Bass TightFuzz is based on consumers' requests for a more tweakable fuzz box, with both Germanium and Silicon transistors. Automatic biasing extends the range from very clean tones to killer fuzz using a single Fuzz control. Keep those ideas coming!

  
*James Brown, Amp Engineer*

**Cool Ideas:**

- True Bypass switching—with special input circuitry, works great with active pickups or other pedals in front!
- Dry Low control blends in dry lowend for big bottom
- Tight Attack control lets YOU dial in the chunk
- Fuzz, Volume, & Tone with 60's-70's Tone switch
- Germanium/Silicon output transistor switch
- Edge switch smoothes out the buzz
- Pre/Post selectable Effects Loop—tracks Bypass Switch
- Battery On/Off switch with red 'Don't Forget' indicator
- LED lit knobs when using a DC adapter

(Bass)

# How does the **amptweaker R6ZZ™** work?

**Transistor SW**—selects Germanium(warmer) or Silicon(brighter/higher gain) output stage transistor

**Tight**— set higher for aggressive, chunky attack or lower for a thicker, fatter distortion

**Volume**—distortion Volume, set for boost or balance with the bypassed levels

**Tone**—EQ, adjusts highs up and down to balance with lows

**Fuzz**— adjusts distortion, while it automatically adjusts bias for better clean tones

**Edge SW**— set to Smooth for a softer and less buzzy tone

**60's-70's Tone SW**—tweaks EQ for bright 60's or full-range 70's fuzztones

**DC Jack**— use regulated 9V–18VDC supply, center pin (-) 9V is the most distorted, while 18V is cleaner, and louder—works better for clean boosting

**Output Jack**— connect to next pedal IN or amp

**Dry Low**—blends in clean lowend for fatter bottom!

**True Bypass SW**—disconnects all circuitry and directly connects Input Jack to the Output Jack

**Input Jack**—from bass or previous effect. The battery disconnects when unplugged



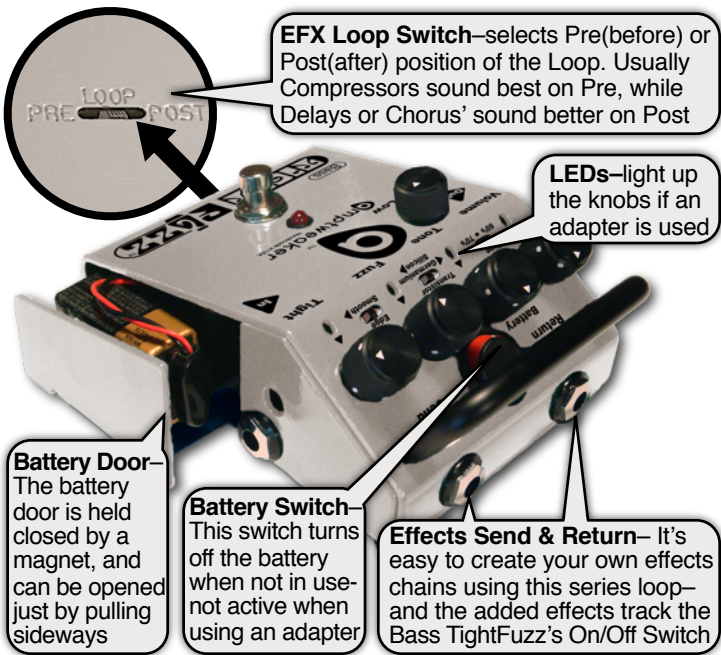

### Specs:

- Input impedance: 250K Ohm (effect on)
- Output Impedance: 1K Ohm (effect on)
- Current: 11mA with 9V battery, 22mA with 9V adapter, 45mA with 18V adapter (adapter adds knob LEDs)
- Adapter: 9-18VDC adapter w/5.5mm X 2.1mm positive barrel, center ground(-)
- Housing: 14 Gauge galvanized steel
- Weight: 2 pounds, Dimensions: 3.75"W X 5"D X 2"H



amptweaker™

## Other Tips & Tricks:

- Effects like compressors, treble boosters, octavers, or overdrives tend to work best in the Effects Loop, set to Pre.
- Effects like EQ, chorus, vibe, delay, reverb and most other mod effects tend to sound best with the Loop set to Post.
- Add an overdrive/distortion pedal in the Effects Loop (set to Pre) to tweak the Bass TightFuzz for more distortion and sustain! The Dry Low will blend in the low part of the drive.
- Add a clean boost or EQ pedal in the Effects Loop (set to Post) for more output level or to further tweak the fuzz tone.
- With higher Volume/lower Fuzz settings, the Bass TightFuzz sounds like a small tube amp(with Tight DOWN, 70's tone, Smooth ON) or a treble booster(with Tight UP, 60's tone).
- For the thickest, buzziest fuzz, use Silicon, 70's, Edge OFF, Fuzz turned UP and Tight turned DOWN. Dry Low to taste.
- Select Pre/Effects Send to use it as a switchable 'clean' send to another effects chain, tuner input or second amp.
- Select Post/Effects Send to send to another amp AFTER the Bass TightFuzz for a big stereo solo tone.
- When using extremely high settings on the Tight control, you will likely need to increase your the Dry Low control.



good tone comes from tweaking . . .

*Amptweaker, LLC*  
5885 Cumming Hwy, Suite 108-98  
Sugar Hill, GA 30518

*handmade in USA*  
[www.amptweaker.com](http://www.amptweaker.com)  
©2013 Amptweaker, LLC